



FABRICASTO

CRAFTING PRECISION | ENGINEERING INNOVATIONS

hansen products

Steel-look & Slimline Solutions

Table of Contents

The Hansen Heritage.....	4
HansenMillennium.....	6
Ultra-Slim Design.....	8
Typical Section.....	14
Various Shapes.....	16
Simulated Divided Lite.....	20
SDL vs TDL - Details.....	22
Solutions.....	24
Handles & Colours.....	26
Fire Safety.....	28
Energy Performance.....	29
Glazing Bead Options.....	30
Easy Installation.....	32
External Glazing.....	36
Joining the windows.....	38
Concealed Sash.....	42
Steel Look Doors.....	44
Standard Doors.....	46
Pivot Doors -	48
Hansen Sliders -	50
Inspirational Projects.....	52
HansenGroup.....	80
Quality & Sustainability.....	82





The Hansen Heritage

Over a Century of Excellence

The brand's history is rooted in the town of **Lem**, Denmark, where in 1909 **Hans Sørensen Hansen** established his first craft workshop, originally known as "Smedjen." The founder's passion for precision metalworking and the initials of his name gave rise to the HS Hansen brand, which over the decades has become a synonym for supreme Scandinavian quality and reliable engineering. For over a hundred years, the company has remained a proud family-owned enterprise, where unique craftsmanship and ethical values are carefully passed down through generations.

Following the founder's pioneering efforts, the company's development was continued by his son, Kristian Hansen, while the third generation is represented by **Hans Magnus Kolby Hansen**, who expanded the business into new territories. Today, this multi-generational mission is carried forward by his son-in-law, Tomas Bur Andersen, who holds executive authority and ensures that modern management always aligns with the family's historical legacy.

1909
Hans S. Hansen founded
a blacksmiths
firm



1929
First Steel
windows

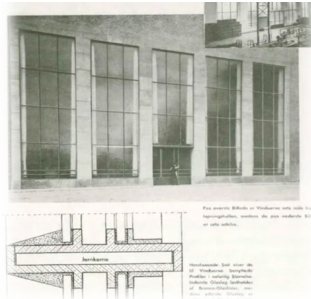

1959
Aluminium
windows&doors

1980
Hansen Denmark
Expand New HQ





hansen
products

2024
Hansen Products

1999/2000
Official Launch
of Hansen Millennium

1997
Foundation of the
Hansen Millennium
concept

1980-2006
Hansen in:
Norway, Sweden,
UK, Germany,
Poland



The Hansen Legacy: Four Generations



**Hans Sørensen
Hansen**



**Kristian
Hansen**



**Hans Kolby
Hansen**



**Tomas Bur
Andersen**

HansenMillennium®

Hansen Millennium was initially crafted to address the challenges of renovating and replacing steel windows in older buildings, particularly tackling issues like cold bridges and inadequate insulation.

It offers a revolutionary solution with the slimmest aluminum profiles available, making it the ideal replacement for traditional steel systems. These slim profiles deliver exceptional thermal performance and modern aesthetics. Its advantages, including a variety of shapes and versatile bending capabilities, align perfectly with contemporary architectural trends favoring slim profiles and authentic dividers.



Main Features

- **Slimline Profiles:** Get the most modern look with super slim aluminum frames - the slimmest on the market!
- **Complex Window Geometries:** Whether you prefer circular or arched windows, we can create them to match your unique taste.
- **Easy Installation:** Enjoy hasslefree installation with preglazed windows, saving you time and effort.
- **Adaptive Design:** Stylebars can be applied on the interior, exterior, or both – offering maximum design & flexibility for bespoke projects.
- **Concealed Sash:** For inward opening windows we have hidden the frame for a sleek and stylish look.
- **Easy Conversion:** Combine traditional curtain wall designs with our innovative window system - enhancing both functionality and aesthetics.
- **Large Dimensions:** Our windows can be impressively large. In fact our largest window to date measured 2,44m (8 feet) in width and 12,8m (42 feet) in height. Imagine the incredible views!
- **Low-emission Aluminium:** The Millennium series utilizes eco-friendly materials, with the option to incorporate recycled content upon request.





Ultra Slim Design

Fixed

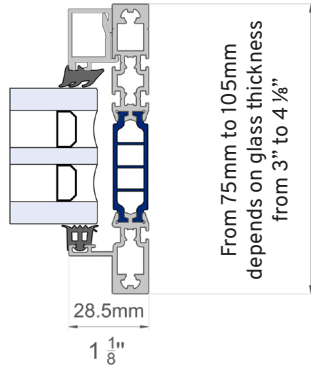

Tilt & Turn Hopper
(concealed hinges)

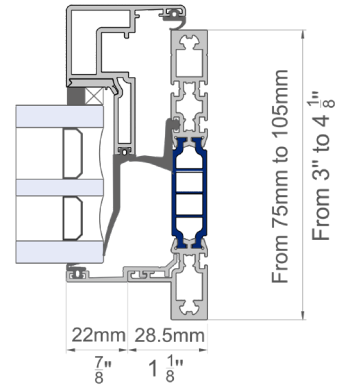

Awning
(concealed hinges)

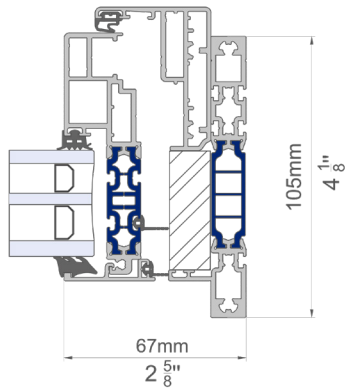

Door & Outward
opening swing windows
(heavy solution, visible hinges)

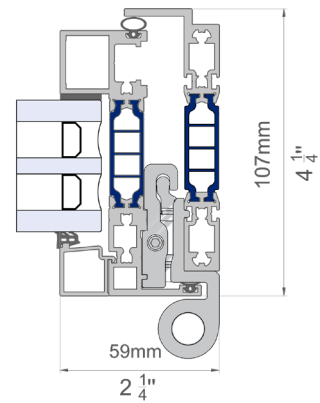

All window solutions can be double or triple glazed

Profiles

All profiles can be manufactured with different "nose" profiles

FLAT

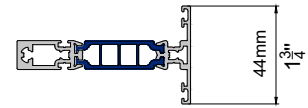

STANDARD

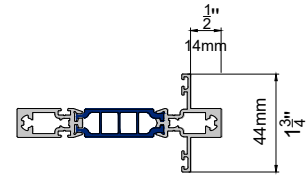
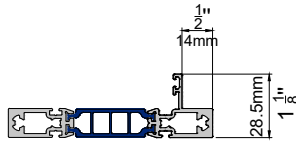

LARGE NOSE

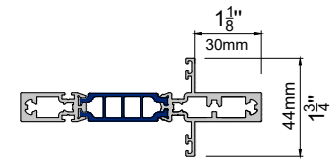
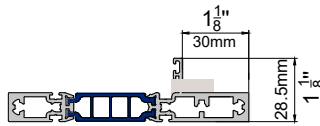

EXTRA LARGE NOSE

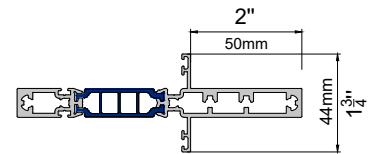
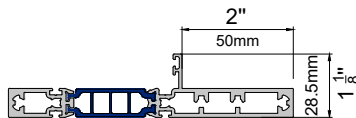

Operable size details

Defining the exact maximum dimensions for **Hansen** Millennium windows can be a challenging task. Defining the exact dimensions for Hansen Millennium Windows requires careful consideration. The size of your windows depends on the width to-height ration and the number of mullions.

Below we present the critical dimensions of window sashes.
We trust that this information will be invaluable during the design phase.

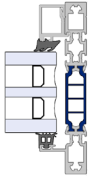
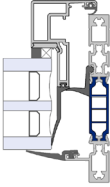
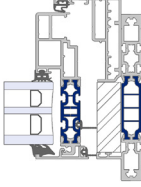
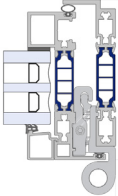
	Fixed	Tilt & Turn Hopper Concealed hinges	Awning Concealed hinges	Door & Outward Heavy solution Visible hinges
				
Max weight	500 kg / 1100 lb	150 kg / 330 lb	180 kg / 400 lb	150 kg / 330 lb
Max area	15 m ² / 160 ft ²	3 m ² / 32 ft ²	3 m ² / 32 ft ²	3 m ² / 32 ft ²
Min. width	200 mm / 8"	480 mm / 1' 7"	510 mm / 1' 8"	600 mm / 1' 12"
Max. width	5900 mm / 19' 4"	1500 mm / 4' 11"	1600 mm / 5' 3"	1500 mm / 4' 11"
Min. height	200 mm / 8"	560 mm / 1' 10"	570 mm / 1' 10"	600 mm / 1' 12"
Max. height	5900 mm / 19' 4"	3050 mm / 10'	2500 mm / 8' 2"	3050 mm / 10'

HansenMillennium versus others

HansenMillennium combines modern design with exceptional functionality, offering numerous advantages compared to standard aluminium windows. Discover why HansenMillennium is an investment that will revolutionize your interior spaces.

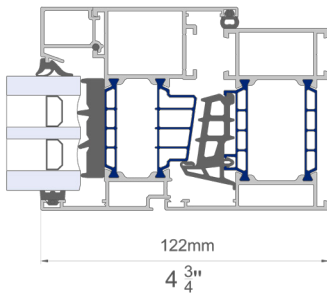

Typical Aluminum
TILT & TURN WINDOW

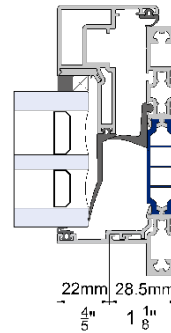

HansenMillennium
TILT & TURN WINDOW

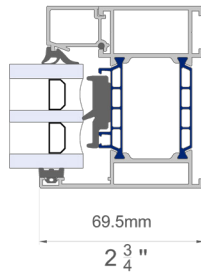

Typical Aluminum
FIXED WINDOW

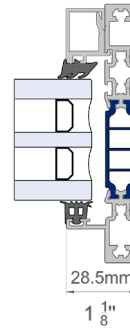

HansenMillennium
FIXED WINDOW

Minimalistic Appearance

HansenMillennium stands out with its elegant, minimalist design. Thanks to its slim profiles, this window perfectly complements both modern and classic interior designs. It provides an unobstructed view of the surroundings, allowing ample natural light to flood your living spaces.

Enhanced Thermal Insulation

Compared to traditional aluminium windows, HansenMillennium offers significantly improved thermal insulation. You can find energy ratings on later pages in this brochure. Utilizing advanced technologies and materials, this window helps minimize heat loss, resulting in lower heating and cooling bills.

Quiet Operation

Thanks to precisely engineered mechanisms of concealed hinges, HansenMillennium operates quietly. You will avoid annoying noises when opening and closing the windows - ensuring daily comfort.

Exceptional Durability

Our slim-profile aluminium windows are designed for durability. Aluminium is corrosion resistant, meaning Hansen Millennium will maintain its excellent properties for years, with minimum need for frequent maintenance.

Tailored to Your Needs

HansenMillennium offers a wide range of customization options, including colors, sizes and types of glass. You can personalize them to your preferences and your home's style.

Typical window system



HansenMillennium



Typical Section

Details



TILT&TURN + FIXED

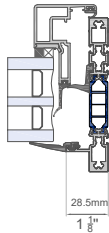
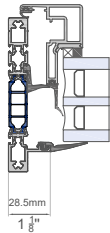
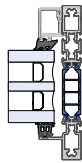
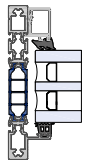
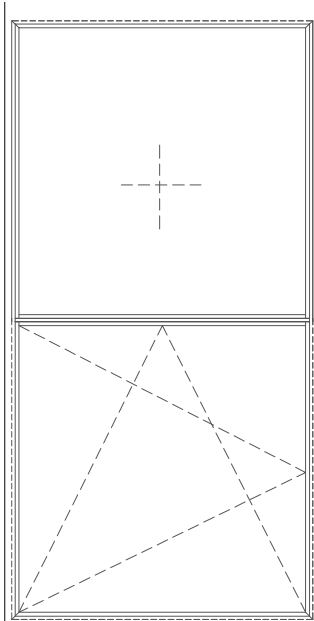

28.5mm
1 1/8"

28.5mm
1 1/8"

AWNING + FIXED

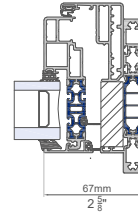
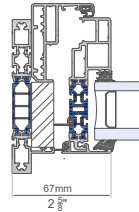
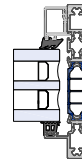
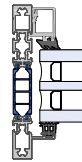
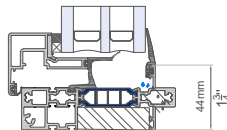
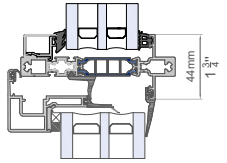
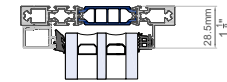
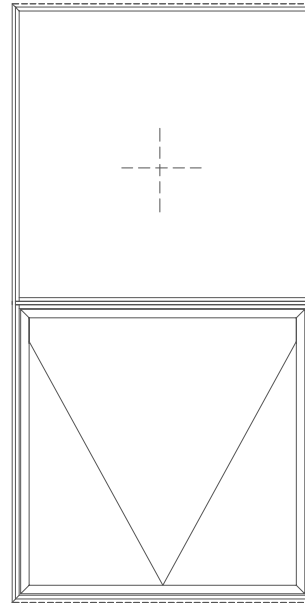

67mm
2 5/8"

67mm
2 5/8"

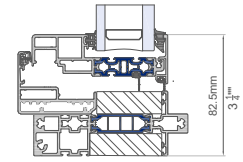
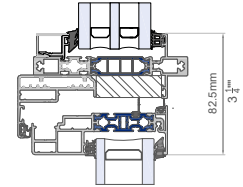
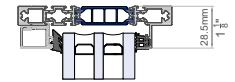

28.5mm
1 1/8"

82.5mm
3 1/4"

82.5mm
3 1/4"

Various Shapes



Examples

HansenMillennium combines modern design with exceptional functionality. In the world of aluminium windows we take pride in offering more than just traditional designs. Our range of unconventional shapes opens doors to endless creative possibilities. From sleek and contemporary to uniquely artistic, our aluminium windows challenge the norm and invite you to explore innovative architectural expressions.

These unconventional shapes go beyond standard rectangles and squares. They offer a canvas for your imagination, making a bold statement in design and functionality. Our windows are not just practical - they are a reflection of your creativity and unique style.

Whether you are an architect seeking to push the boundaries of design, a homeowner yearning for windows that stand out or a builder looking to make a statement, our aluminium window shapes have you covered. They are a testament to the infinite possibilities aluminum can offer, delivering both aesthetics and performance.



Your unique ideas are our inspiration

Below are just a few typical examples of window shapes that can be made - but do not hesitate to share your special design ideas with us.

All shapes are based on a combination between true dividers and grids/stylebars if necessary.

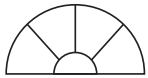

HALF ROUND



HALF ROUND

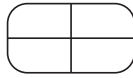

ROUND CORNERS

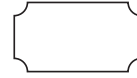

INVERTED ROUND CORNERS

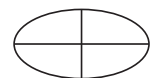

ELLIPSE

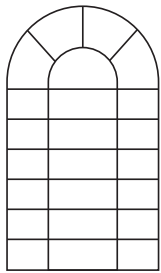

ROUND TOP

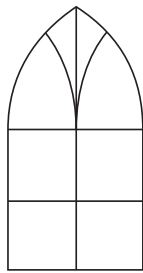

GOTHIC

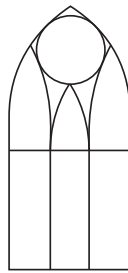

GOTHIC

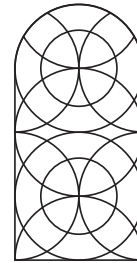

ROUND TOP

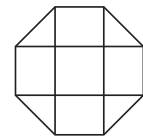

POLYGON

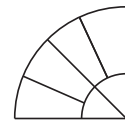

HALF ROUND

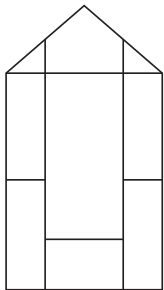

REAK

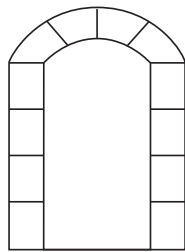

SEGMENTED ROUND TOP

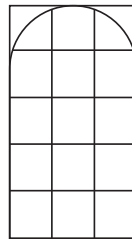

SIMULATED ROUND TOP

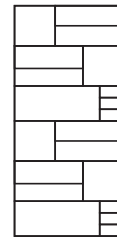

RECTANGLE

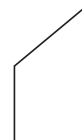

TRAPEZOID

and many others ...



Simulated Divided Lite

SDL are a decorative element that can be added to windows to enhance their visual appeal. These bars are designed to mimic the look of traditional windows with divided panes.

Simulated Divided Lite (SDL)

This solution has the advantage of providing a consistent and indistinguishable external appearance between our stick-on grids and true dividers.

This makes maintenance easy and enhances the overall curb appeal of your property, while offering customization options to suit your design preferences.

We pay attention to detail!

Special attention should be given to details like how the stick-on profile is trimmed when used with an opening window.

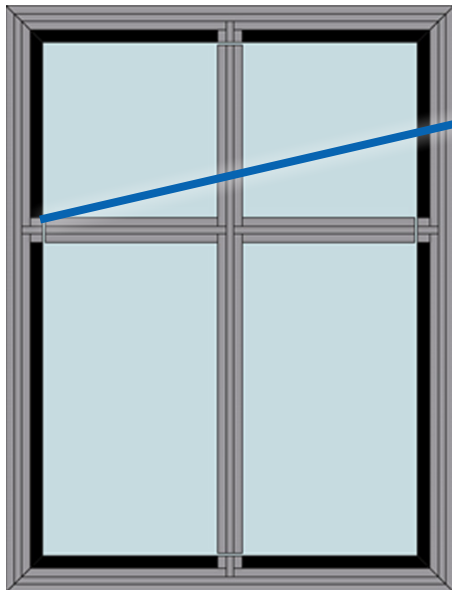
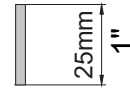
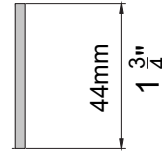
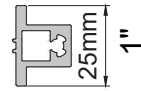
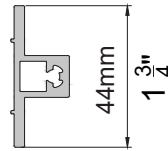

SDL vs TDL Details



SDL (Simulated Divided Lites) vs TDL (True Divided Lites)

Our SDL grids can have the same size as true divider profiles - they look identical from the outside. But if you are looking for a slimmer SDL profile, it is also an option. They can be supplied in two different colors to match your interior.

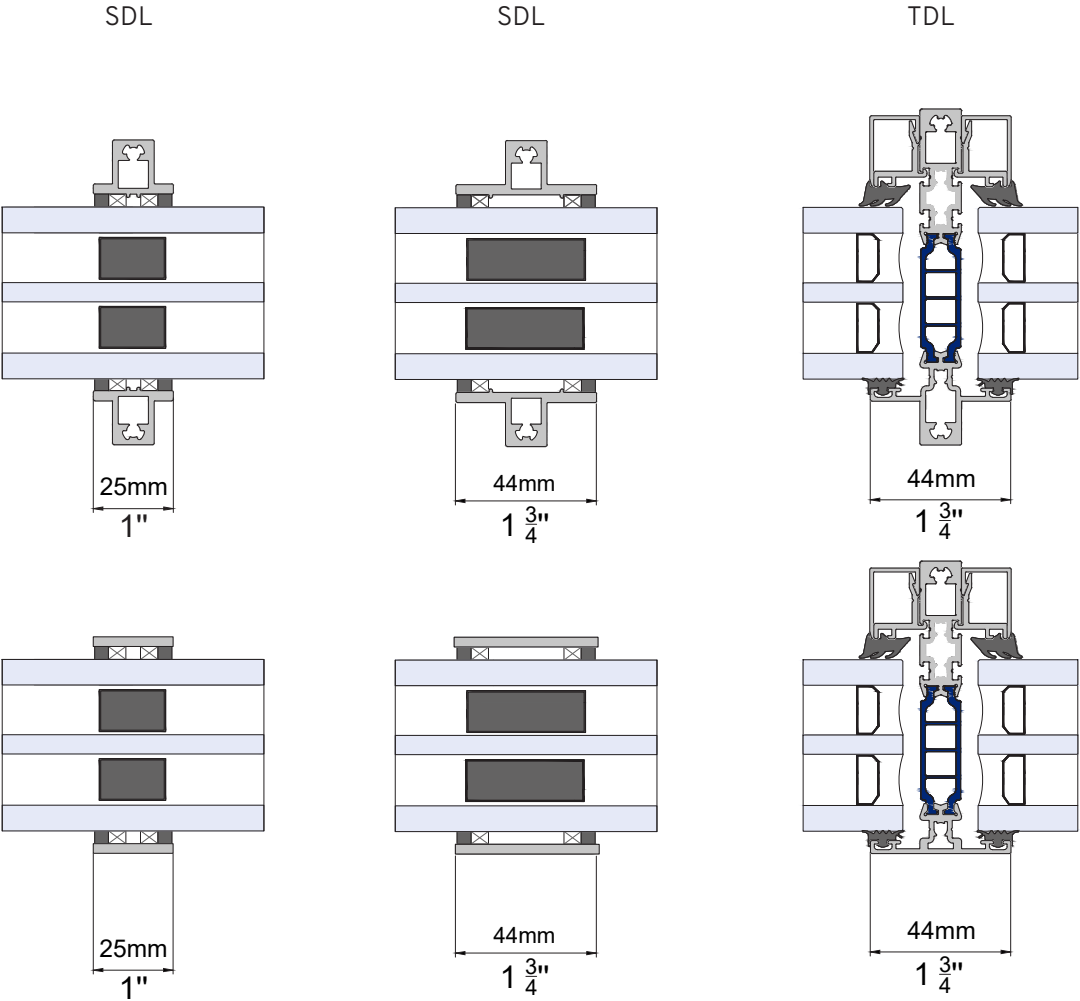

Solutions

The opening function for windows and doors depends on several factors such as the design, layout, and purpose of your space. By selecting the right opening function, you can improve the aesthetics, functionality, and security.



Window
Fixed

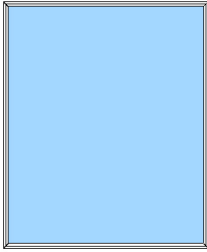

Tilt&Turn (Hopper)
Inward opening

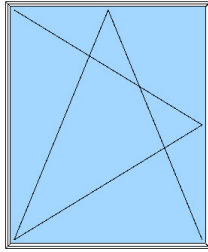

Awning (Top Hung)
Outward opening

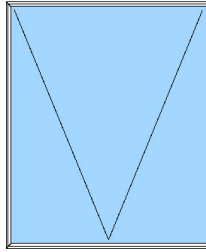

Outward opening

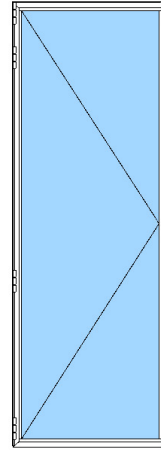

Single steel look door
Outward & Inward opening

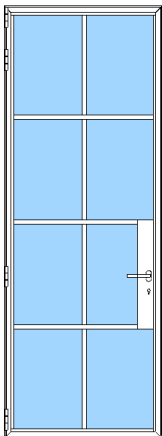

Double steel look door
Outward & Inward opening

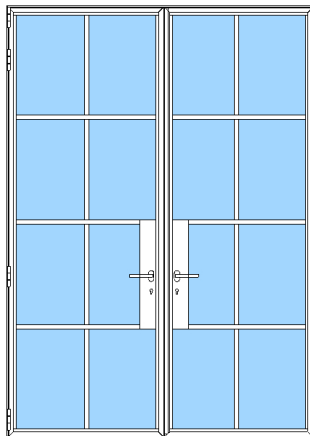

Arched single door
Outward & Inward Opening

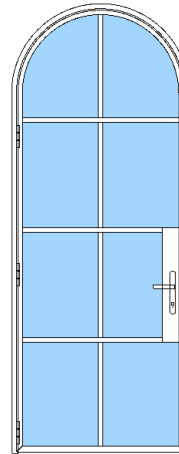

Arched double door
Outward & Inward Opening

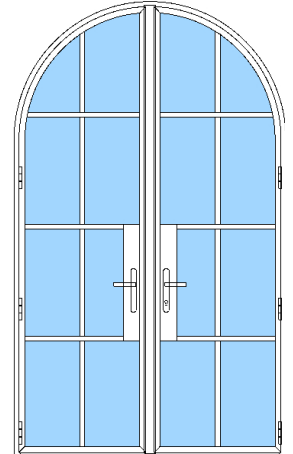

Handles

Window and door handles are crucial for both function and aesthetics. We offer standard handles, but can also provide unique custom-made handles to match style and preferences. The classic handles can be supplied in RAL colours or natural stainless steel.

Prime select **S** **B**



Steel soft **S** **R**



Steel touch **R**



Flexa flow **R**



Retro steel **R**



S Stainless steel natural

B Stainless steel Black

R All RAL color

Colours

HansenMillennium windows and doors are delivered with surface treatment customized to our customers preferences and architectural style.

We offer our windows and doors in all RAL colours, special colour or anodized aluminium.

It is possible to use different colours for the exterior and interior of the windows.



Windows & Doors



Fire Safety

HansenMillennium E160 has been tested for fire resistance from both the inside and outside according to EN 1364-1:2015.

The fire test of Hansen Millennium E160 includes window elements and is only approved as fixed window sections.

HansenMillennium E160 is based on the Hansen Millennium system.

Therefore, it can be combined with standard windows without any visual difference.

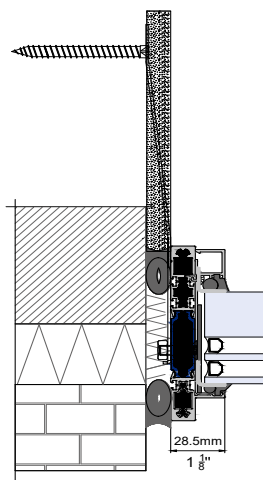

Energy Performance

Hansen Millennium windows and doors have undergone thorough testing, and their thermal resistance has been certified by the National Fenestration Rating Council (NFRC).



Window Section	Sections	DGU (Ug=1,0) Double glass unit	TGU (Ug=0,5) Triple glass unit
		<p>1,2 W/(m²K) 0,32 Btu/h ft² °F</p>	<p>0,75 W/(m²K) 0,19 Btu/h ft² °F</p>
		<p>1,3 W/(m²K) 0,32 Btu/h ft² °F</p>	<p>0,84 W/(m²K) 0,19 Btu/h ft² °F</p>
		<p>1,3 W/(m²K) 0,35 Btu/h ft² °F</p>	<p>0,91 W/(m²K) 0,24 Btu/h ft² °F</p>
		<p>1,3 W/(m²K) 0,35 Btu/h ft² °F</p>	<p>0,91 W/(m²K) 0,24 Btu/h ft² °F</p>

Glazing Bead Options

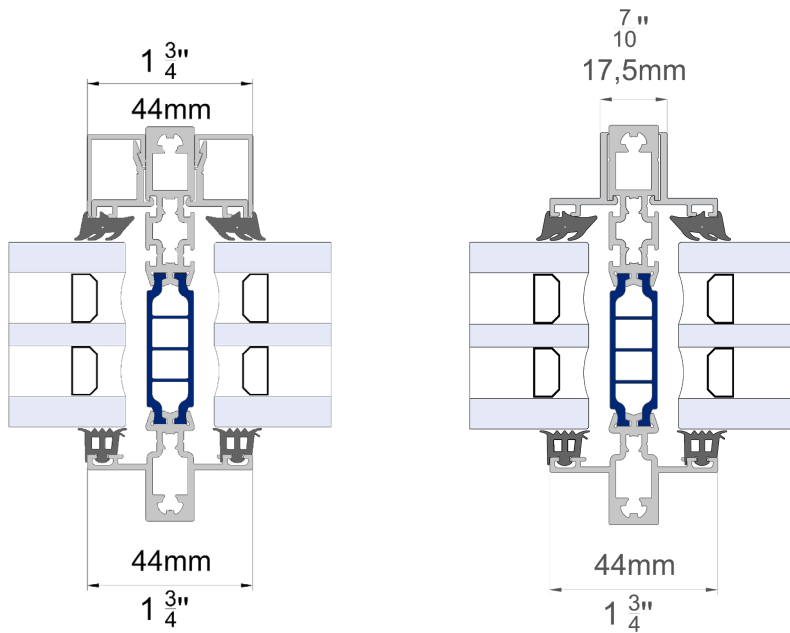

Window installation has never been easier!

- Double glazing bead
- Installation direct through frame with factory prepared holes
- Fully glazed window sections without the need to remove the glass

Double glazing bead

The glazing bead inside the window, pre-drilled during manufacturing, holds the glass in place.

Optionally, you can use an angled L shape glazing bead that emphasizes the slimness of the profiles and makes them resemble steel elements.

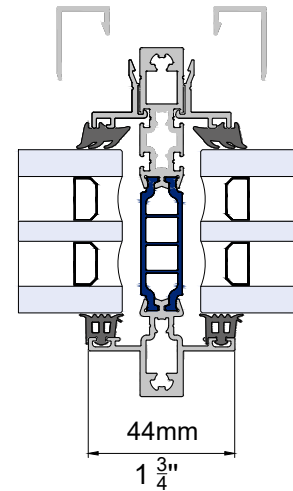
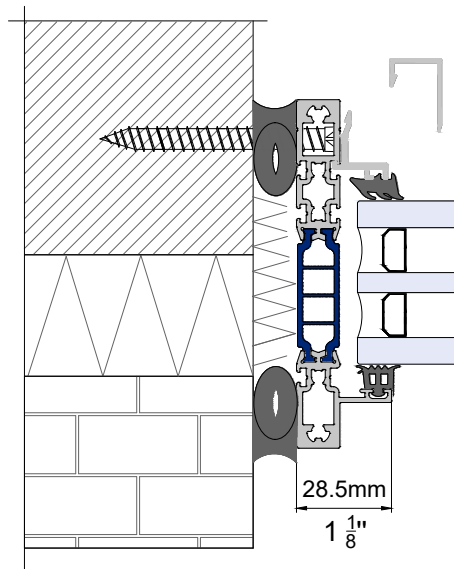

Easy Installation

Three recommended ways of installing fully glazed windows



Option 1: Installation direct through frame

The first and most popular is the previously shown "directly through frame" installation.

Tilt & Turn

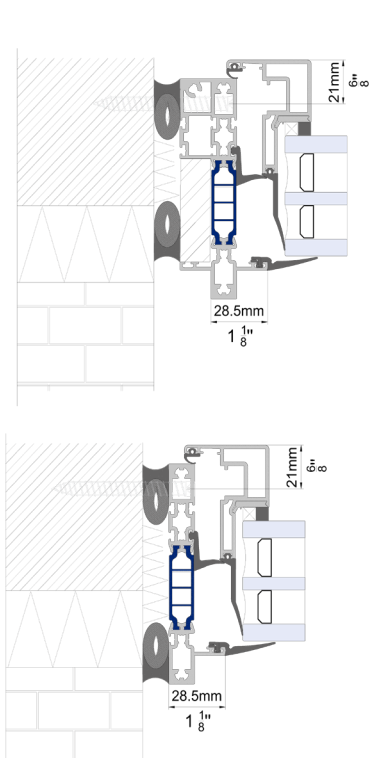

Bottom Frame Detail/Drainage

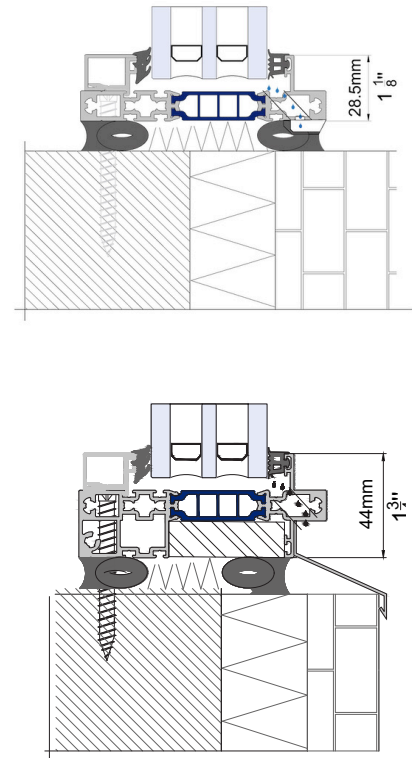

Option 2: Nail flange

Only recommended for FIXED (non-openable) elements.

The second method of installation involves using a nail flange.

Our nailing flange plays a pivotal role in securing your window to the wall sheathing during installation, ensuring a stable foundation for further adjustments with shims and screws.

This flange is not just about structural integrity; it also works in harmony with flashing and a weather resistant barrier to safeguard your home against wind and water, providing peace of mind and long-lasting protection.

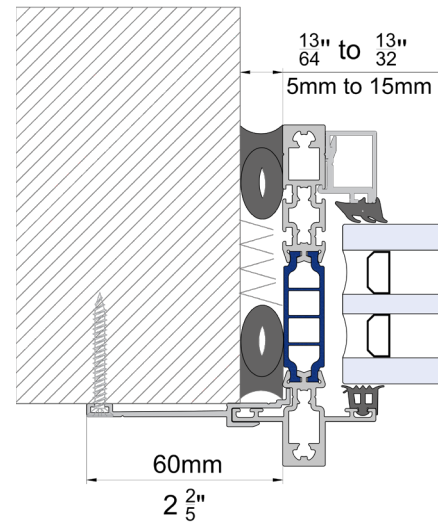

Option 3: with brackets

The final type of installation involves using brackets, which can either be standard or custom made to suit the specific project requirements.

Brackets enable to offset the window relative to the supporting wall by a few inches.

The system was designed for functionality and ease of use by installers if typical installation direct through frame is not possible.

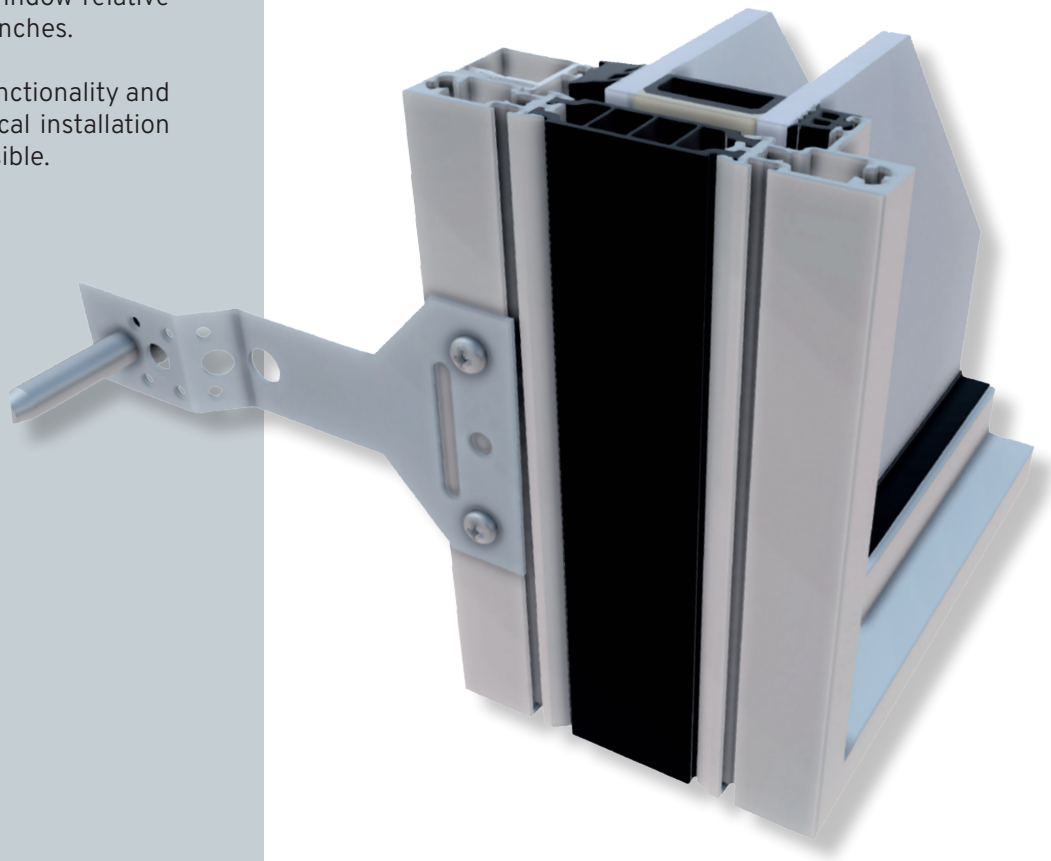

External Glazing

Great solution for spandrel areas

Internal double-glazing
bead system

Outside

Inside

External glazing beads

HansenMillennium offers the option to use a glazing bead on the exterior side as well.

This is an ideal solution for spandrel panels, allowing for glass replacement at any time when there is no interior access to the window.

External glazing bead

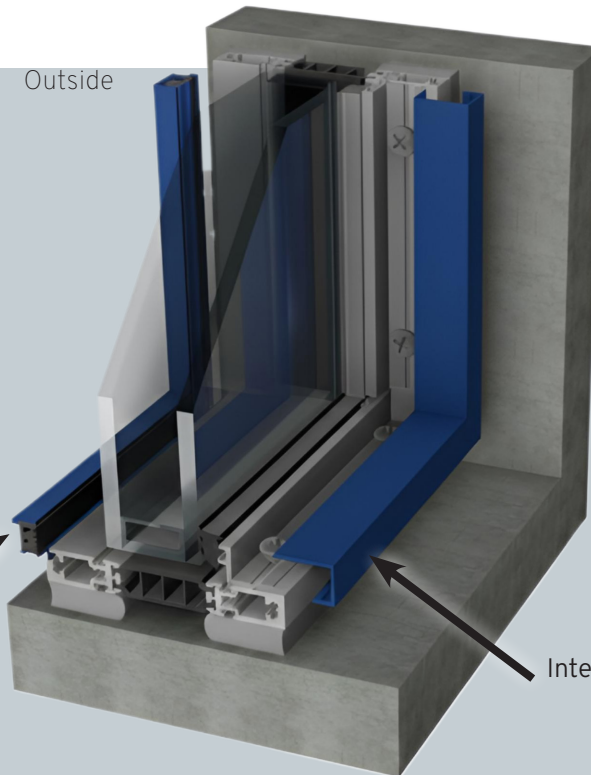

Internal glazing bead

External glazing

Below you will see typical section details that demonstrate how the profile looks the same whether it has an external glazing bead or not. There is no noticeable difference.

Internal Glazing

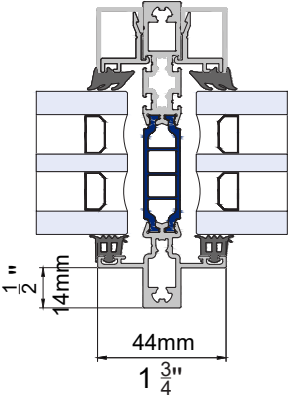

External Glazing

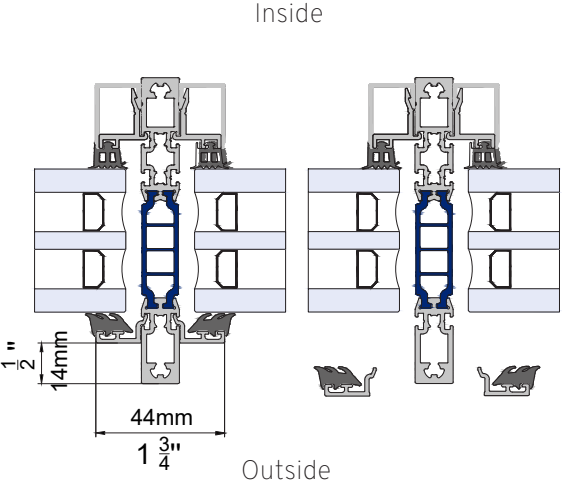

Joining the windows

For easier delivery & better statics



The HansenMillennium window system makes it easy to connect window partitions.

This also means that we can replace traditional curtain walls with our slim-profile window system while meeting technical requirements.

Check out the elegance of our reinforcing profiles.

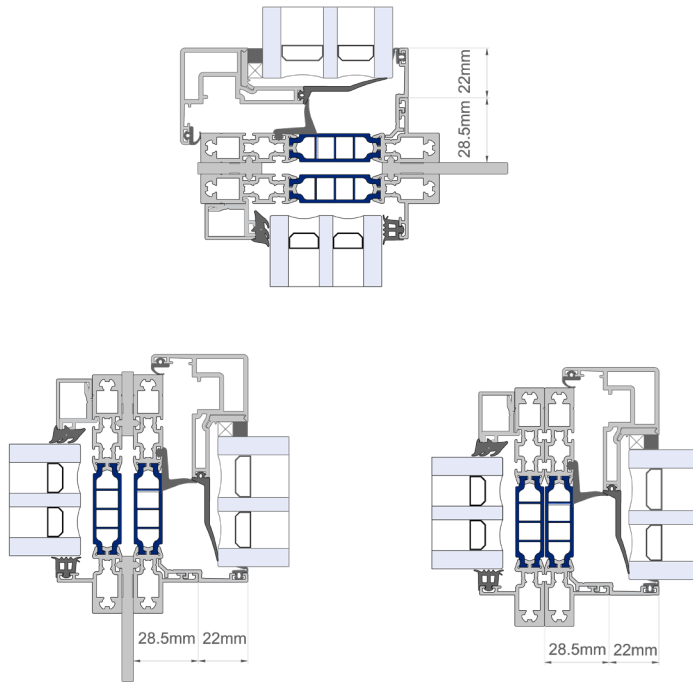

Connection/Reinforcement profiles sizes possibility

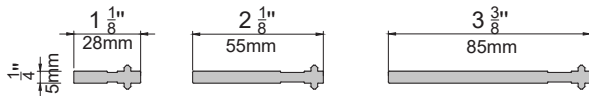

Showcase project

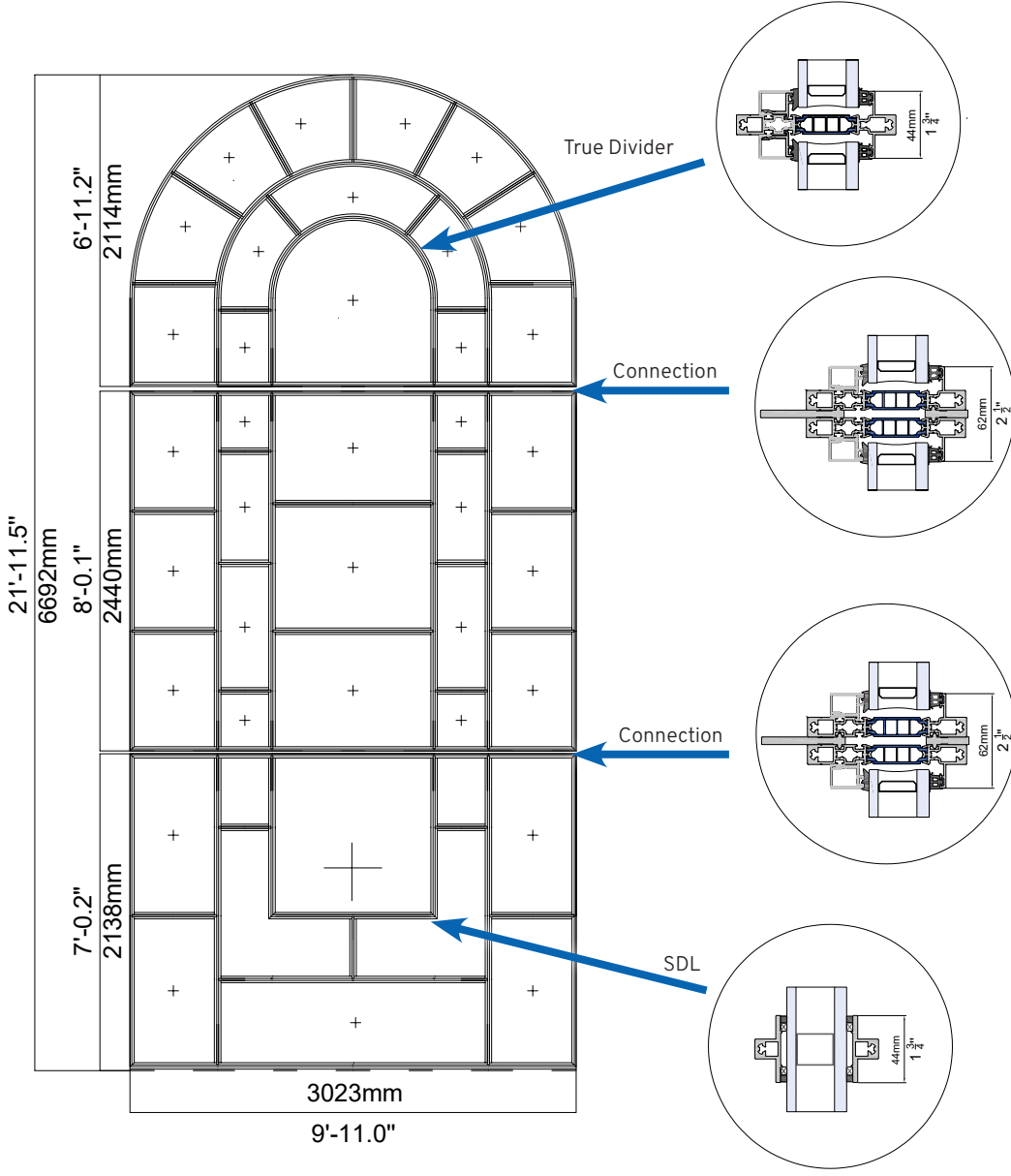



Concealed Sash

For inward opening windows we have hidden frame, so it is practically invisible from the outside.





Steel Look Doors

Inward & Outward opening



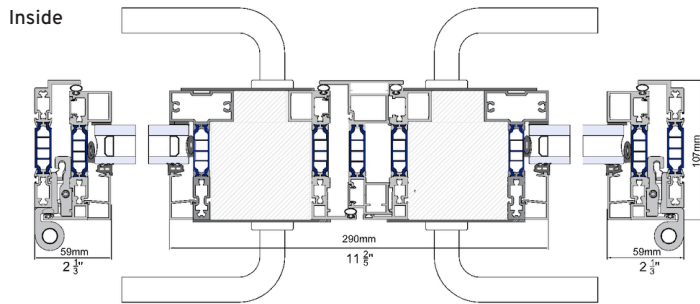
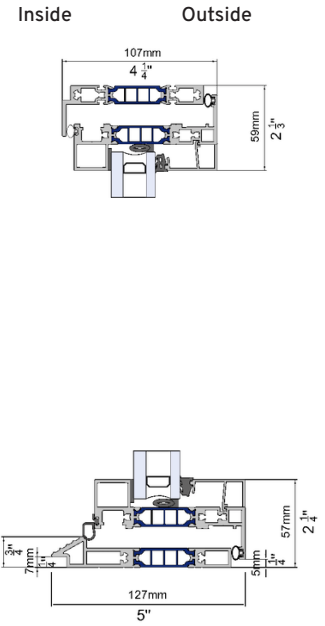
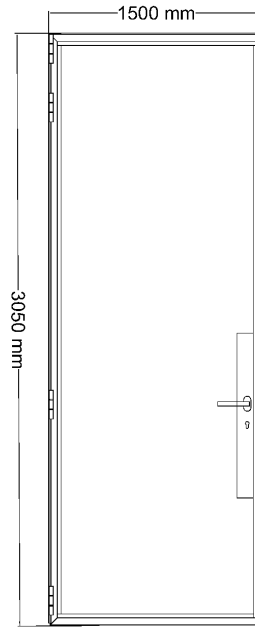
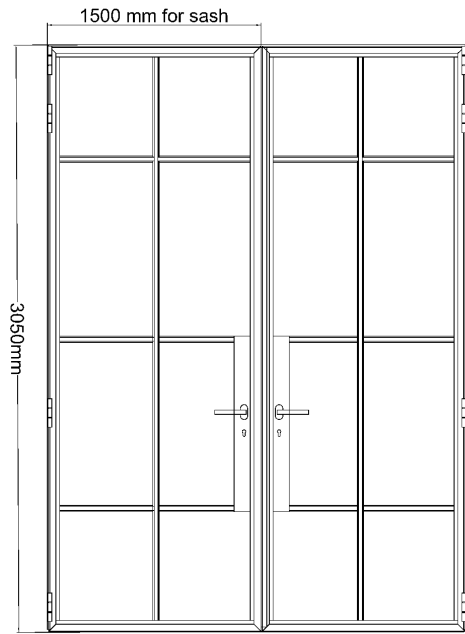

Outside

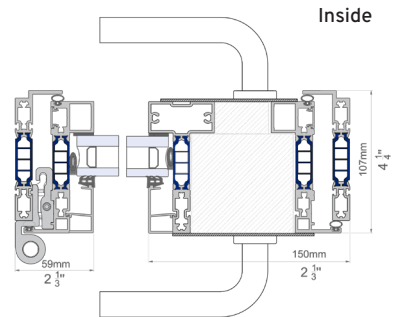

Outside

Standard Doors

Inward & Outward opening



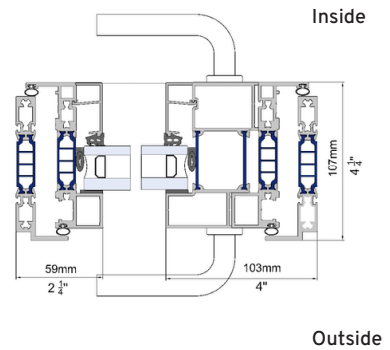
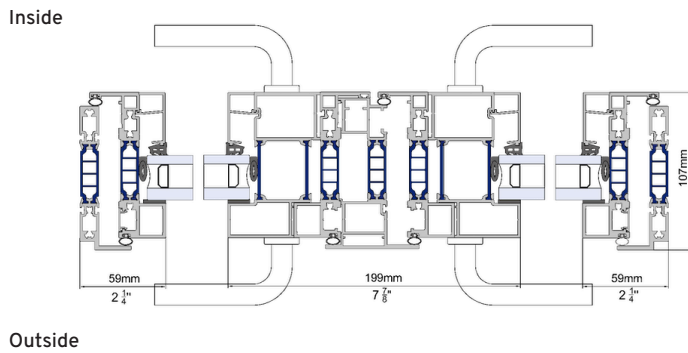
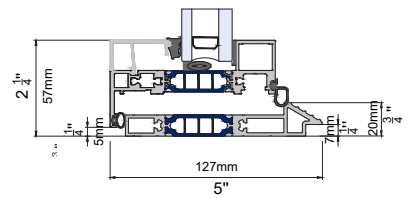
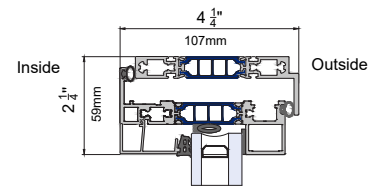
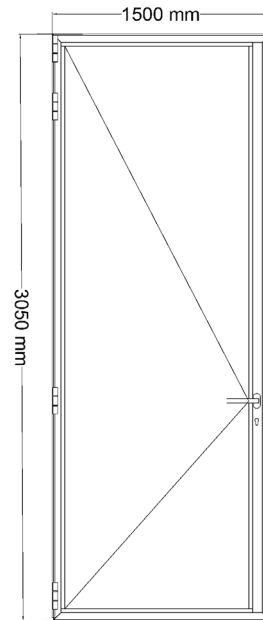
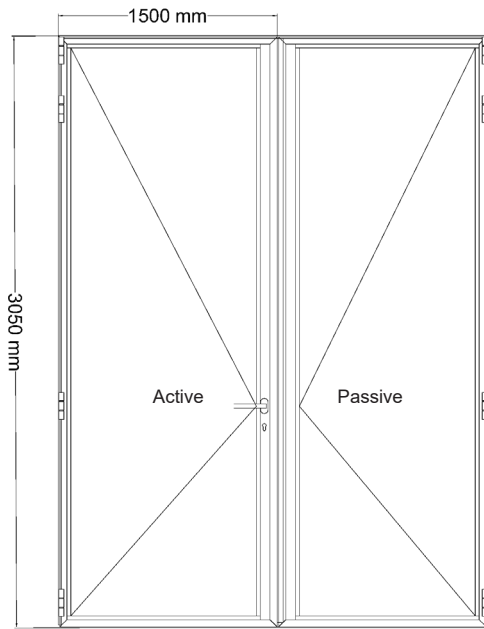

Pivot Doors - Sosoares Line

The OS-Pivot system is a prestigious addition to the Sosoares minimalist line. This pivot door and window system allows for the creation of spectacular, rotating glass panels. It is the ideal solution for grand entrances and modern residential facades that demand a statement piece.

Why Choose OS-Pivot?

Innovative Construction: Built on 71 mm (2³/₄") deep profiles with a thermal break, it stands out from traditional pivot solutions by offering superior insulation.

Invisible Support: Hidden pivot axes and the ability to flush the threshold with the floor level ensure total visual consistency.

Spectacular Glazing: The system supports glass packages up to 56 mm (2³/₁₆") thick (tempered glass), providing exceptional acoustic insulation and security.

Powerful Capabilities: The mechanism effortlessly handles panels weighing up to 500 kg (1102 lbs) guaranteeing quiet and light operation even at maximum dimensions.

Security and Durability: Designed for high resistance and longevity, the system is equipped with multi-point locking mechanisms for ultimate peace of mind.

“OS-Pivot transforms a standard opening into an architectural event, combining monumental form with effortless ease of use.”

minimum 200mm 7⁷/₈" without reinforcement
or 350mm 13³/₄" with reinforcement

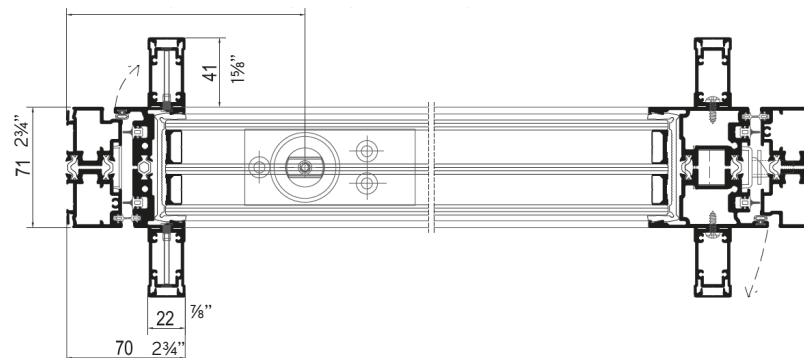

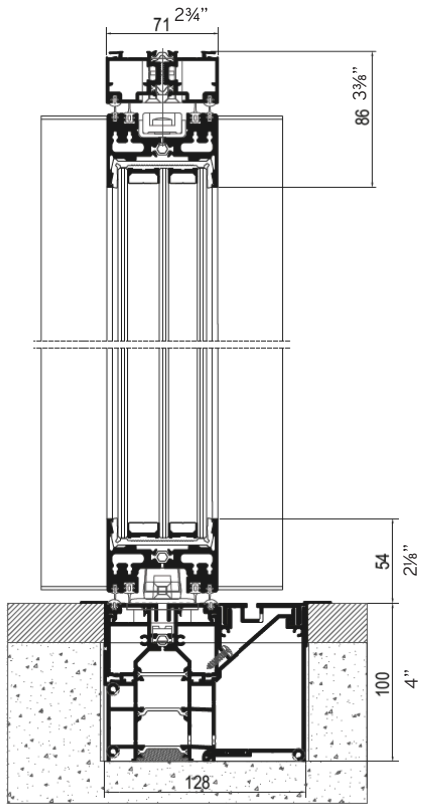

Hansen Sliders - Sosoares Line

The Hansen Sliders - the quintessence of modern architecture, where maximum natural light is the priority. This minimalist sliding series has been specifically designed for large-scale glazing, offering an almost limitless field of vision while maintaining the highest thermal insulation standards.

Key Features and Benefits:

Ultra-Slim Profiles: The visible interlocking section (where the panes meet) is just 20 mm [$\frac{3}{4}$ "] wide, making the frame nearly invisible.

Impressive Dimensions: The DGU (Double Glass) system allows for the creation of individual glass leaves up to 8 m² [86 sqft] in area and up to 4 meters [13 feet] in height. With TGU (Tripple glass) possible is 14 m² [151 sqft] and 6m [20 feet] height.

Load Capacity and Precision: Advanced stainless steel rollers ensure the smooth operation of sashes weighing up to 500 kg [1102 Pounds] (DGU) and 1000 kg [2205 Pounds] (TGU)

Concealed Installation: The frame 121mm [$4\frac{3}{4}$ "] for double glass and 170 mm [$6\frac{1}{16}$ "] for triple glass s designed to be fully integrated into walls, ceilings, and floors, providing a seamless, barrier-free threshold.

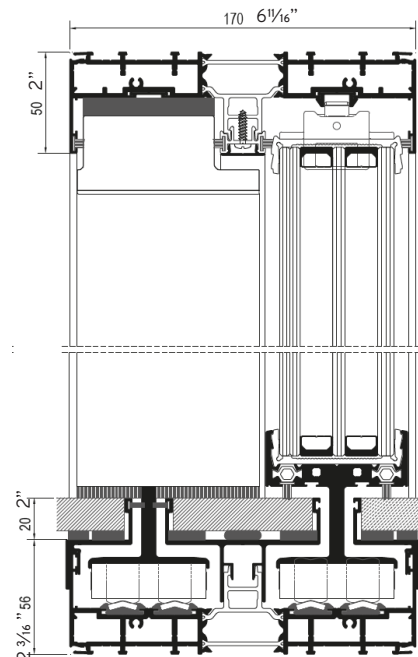
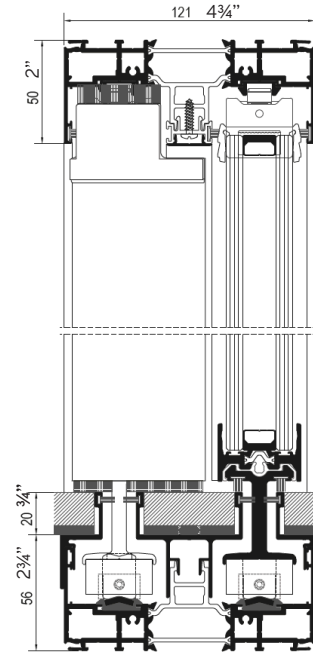



SANTA POLA HOUSE | SPAIN | FRAN SILVESTRE ARCHITECTURE | FERNANDO GUERRA PHOTOGRAPHY

Inspirational Projects









55



56

65













































BAUHAUS



HansenGroup

HansenProducts is part of the HansenGroup, a company with over **100 years of heritage** in engineering and fenestration solutions.

We operate modern design, project management, and production facilities across **Denmark, Sweden, Norway, Poland, and the United Kingdom.**

Our products are installed on multiple continents, and Hansen solutions can be found in landmark residential, commercial, and cultural projects around the world.



We operate through a unique international network with locations in Denmark, Poland, United Kingdom, Sweden, and Norway.

Our organisation is equipped to support projects of all scales – from bespoke residential villas to complex, large-scale commercial developments across international markets.

We build on strong traditions of quality craftsmanship, combining them with modern production methods, professional project management, and a highly qualified technical team.

We work in close collaboration with architects, developers, main contractors, and specialist steel window and façade installers to deliver unique, cost-effective, and sustainable solutions tailored to each project.



Quality & Sustainability

We prioritize delivering high-quality, defect-free construction on time and at the agreed-upon price.

We work with a modern quality assurance system which is an integral part of our manufacturing and construction process.

The quality assurance system follows the window all the way through the factory and finishes when the window is installed in its final position.



HansenGroup is dedicated to meeting the highest demands for energy performance in windows. Our designs prioritize energy efficiency to provide a comfortable indoor environment while minimizing energy consumption and costs.

Over the years, we have been involved in a wide range of projects which have obtained certifications such as DGNB, LEED and BREEAM.

We have a longstanding tradition of actively collaborating with designers to identify and implement solutions that promote positive change and improve the overall impact of our practices. This includes the selection of materials, indoor climate and working environment, and energy savings focus during construction process of minimizing waste.

HansenGroup employees, through their personal qualities and competencies, contribute to our ability to efficiently adapt the process and production towards energy efficient construction.

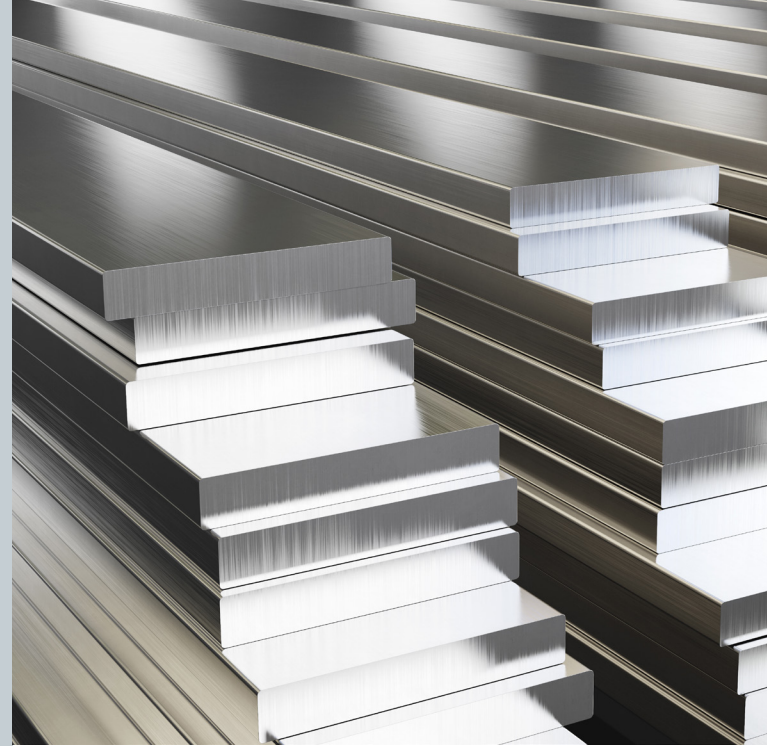

We can, upon request, provide our HansenMillennium windows and doors in recycled aluminum or low-emission aluminum from our supply chain.

Glass and aluminum are generally recycled and our regular waste collection partner is environmentally certified.



Address: 341, CRC Estate, MG Road,
Sultanpur, New Delhi, India - 110030

E-mail: Jatin@fabricasto.com

Phone : +91 981 863 0247



W: hansen-products.com

hansen products

4-th Edition, A 2026